

# Piston Valve YVN 15-50

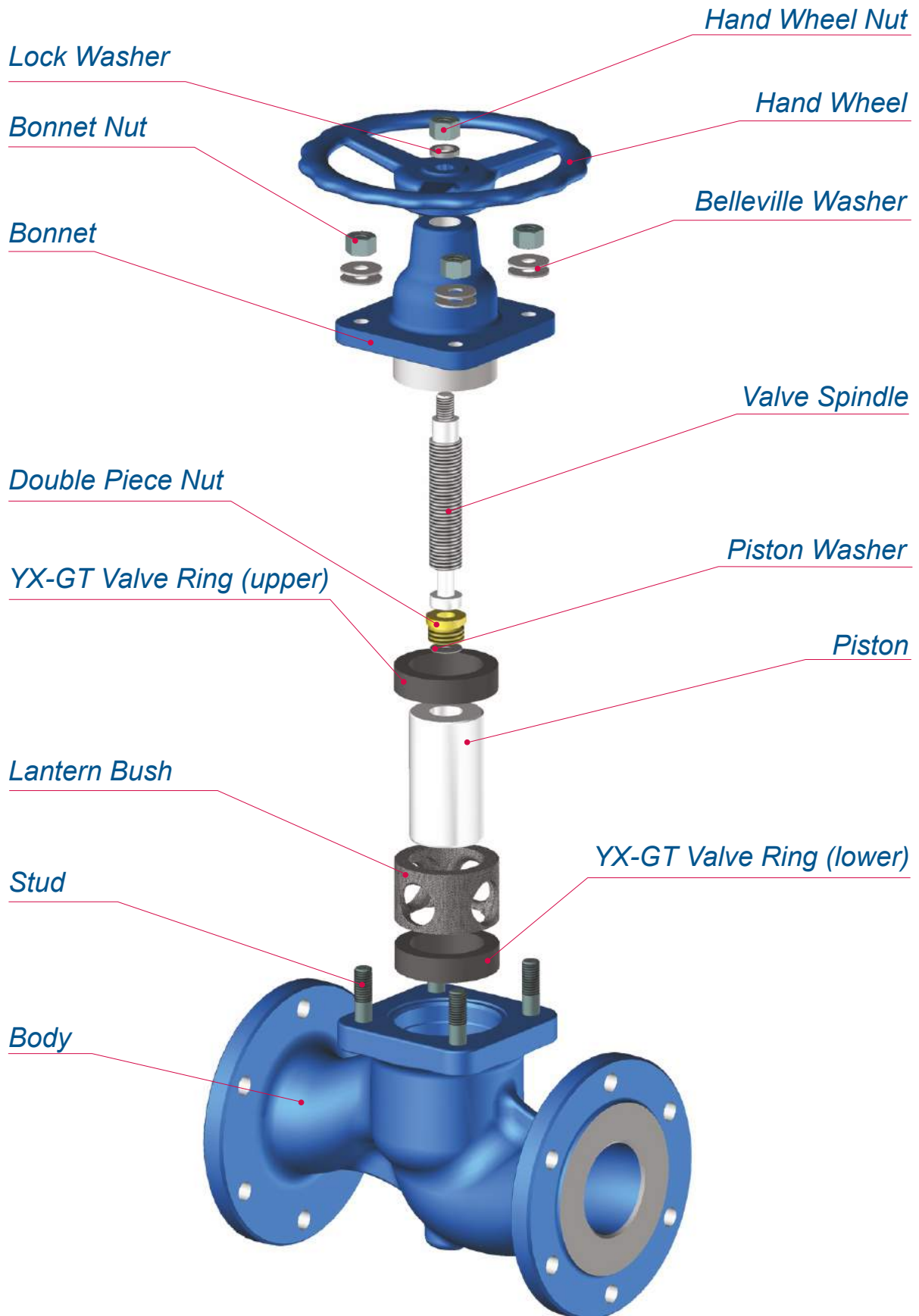

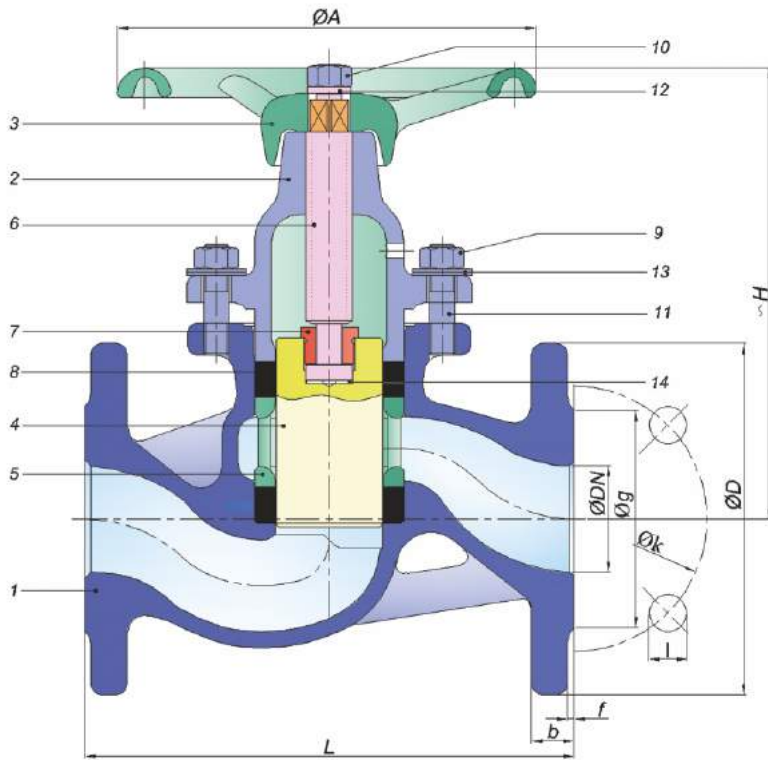

# Piston Valves

## DN 15 - 50

### Type: YVN Flanged

Material Type	Cast Iron	Ductile Iron	Cast Steel	Stainless Steel
Size	DN15-50	DN15-50	DN15-50	DN15-50
Pressure Class	PN16	PN25	PN40	PN40
Dimensions	DIN EN 558/1.serie	DIN EN 558/1.serie	DIN EN 558/1.serie	DIN EN 558/1.serie
Assembly	Flanged according to DIN EN 1092-2	Flanged according to DIN EN 1092-2	Flanged according to DIN EN 1092-1	Flanged according to DIN EN 1092-1
Temperature	-10°C +300 °C	-10°C +350 °C	-10°C * +400°C	-10°C * +400°C
Material Code	2	8	7	9
Order Code	YPG.2F__00	YPG.8F__00	YPG.7F__00	YPG.9F__00

### Fluid Types

All kinds of fluids such as water, hot water, high temperature hot water, steam, thermal oil, LPG, fuel oil, pressurized air, etc.

P.No	Part Name	Cast Iron	Ductile Iron	Cast Steel	St. Steel	St. Steel
1	Body	GJL 250	0.7040	1.0619	1.4308	1.4408
2	Upper Bonnet	GJL 250 ****	0.7040 ****	1.0619 ****	1.4308	1.4408
3	Hand Wheel	GJL 200	GJL 200	GJL 200	GJL 200	GJL 200
4	Piston	1.4021	1.4021	1.4021	1.4301	1.4401
5	Lantern Bush	GJL 200 + Phosphate	GJL 200 + Phosphate	GJL 200 + Phosphate	1.4308***	1.4408***
6	Valve Spindle	1.4021/St-42	1.4021/St-42	1.4021/St-42	1.4301	1.4401
7	Double Piece Nut	Ms-58	Ms-58	Ms-58	1.4301	1.4401
8	Valve Ring	Graphite	Graphite	Graphite	Graphite	Graphite
9	Nut	8.8+Gal.	8.8+Gal.	8.8+Gal.	A2-70	A2-70
10	Nut	8.8+Gal.	8.8+Gal.	8.8+Gal.	A2-70	A2-70
11	Stud	8.8+Gal.	8.8+Gal.	8.8+Gal.	A2-70	A2-70
12	Lock Washer	8.8+Gal.	8.8+Gal.	8.8+Gal.	A2-70	A2-70
13	Belleville Washer	50CrV4	50CrV4	50CrV4	A2-70	A2-70
14	Piston Washer	Ms-58	Ms-58	Ms-58	1.4301	1.4301

DN		Dimensions			Assembly size													
mm	inch	Type	L	H	A	D	g	Hole Nr.	k	PN16			PN25			PN40		
										b	f	l	b	f	l	b	f	l
15	1/2"	YVN 15	130	105	100	95	45	4	65	14	2	14	16	2	14	16	2	14
20	3/4"	YVN 20	150	120	120	105	58	4	75	16	2	14	18	2	14	18	2	14
25	1"	YVN 25	160	138	140	115	68	4	85	16	2	14	18	3	14	18	2	14
32	1 1/4"	YVN 32	180	154	160	140	78	4	100	18	2	19	18	3	19	18	2	18
40	1 1/2"	YVN 40	200	186	180	150	88	4	110	18	3	19	18	3	19	18	2	18
50	2"	YVN 50	230	211	200	165	102	4	125	20	3	19	20	3	19	20	2	18

\* For temperatures below -10°C, stud and nut material should be stainless steel  
 \*\*\*1.4401 for DN15 and DN20  
 \*\*\*\* Ck22 for DN15 and DN20

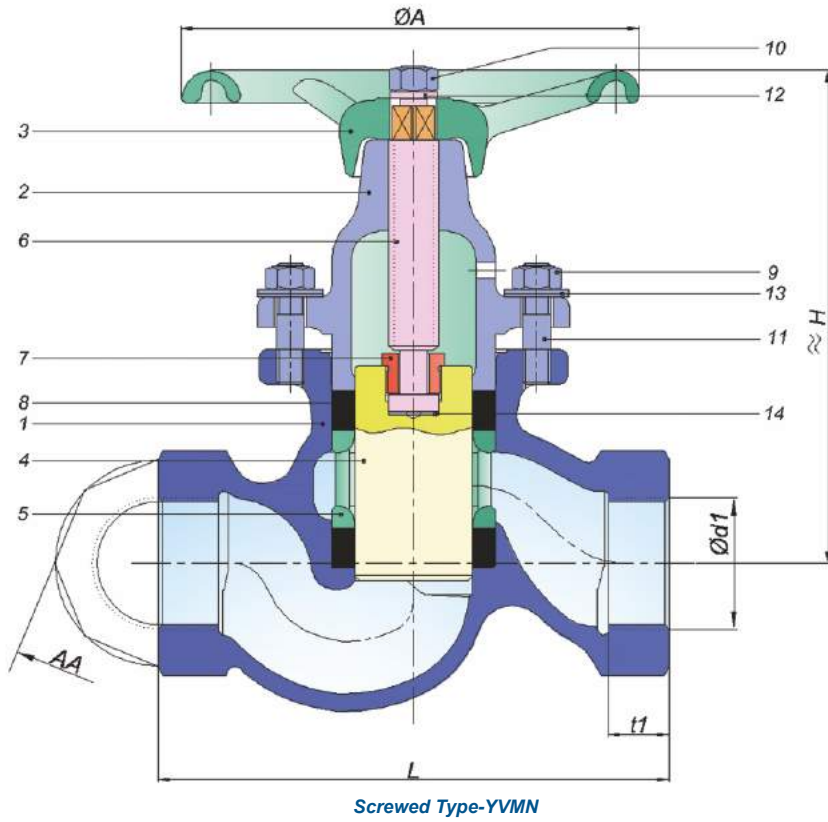

Screwed Type-YVMN

## Piston Valves

### DN 1/2"-2"

### Type: YVMN Screwed

### YVSN Socket Weld

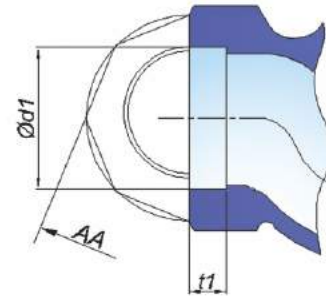

Socket type - YVSN  
(For steel and stainless steel)

Material Type	Cast Iron	Cast Steel	Stainless Steel
Size	DN1/4"-2"	DN1/4"-2"	DN1/4"-2"
Pressure Class	PN16	PN40 DN 1/4"-2" PN63 DN 1/4"-1"	PN40 DN 1/4"-2" PN63 DN 1/4"-1"
Dimensions	DIN EN 3202-4/M9 (Except DN 1/4")	DIN EN 3202-4/M9 (Except DN 1/4")	DIN EN 3202-4/M9 (Except DN 1/4")
Assembly (Screwed)	Screwed according to DIN EN ISO 228-1	Screwed according to DIN EN ISO 228-1	Screwed according to DIN EN ISO 228-1
Assembly (Socket)	—	Socketed according to DIN EN 12760*****	Socketed according to DIN EN 12760*****
Temperature	-10°C +300 °C	-10°C * +400 °C	-10°C * +400 °C
Material Code	2	7	9
Order Code (Screwed)	YPG.2M.__.00	YPG.7M.__.00	YPG.9M.__.00
Order Code (Socket)	—	YPG.7S.__.00	YPG.9S.__.00

### Fluid Types

All kinds of fluids such as water, hot water, high temperature hot water, steam, thermal oil, LPG, fuel oil, pressurized air, etc.

P.No	Part Name	Cast Iron	Cast Steel	St. Steel	St. Steel
1	Body	GJL 250	1.0619	1.4308	1.4408
2	Upper Bonnet	GJL 250 ****	1.0619 ****	1.4308	1.4408
3	Hand Wheel	GJL 200	GJL 200	GJL 200	GJL 200
4	Piston	1.4021	1.4021	1.4301	1.4401
5	Lantern Bush	GJL 200 + Phosphate	GJL 200 + Phosphate	1.4308***	1.4408***
6	Valve Spindle	1.4021/St-42	1.4021/St-42	1.4301	1.4401
7	Double Piece Nut	Ms-58	Ms-58	1.4301	1.4401
8	Valve Ring	Graphite	Graphite	Graphite	Graphite
9	Nut	8.8+Gal.	8.8+Gal.	A2-70	A2-70
10	Nut	8.8+Gal.	8.8+Gal.	A2-70	A2-70
11	Stud	8.8+Gal.	8.8+Gal.	A2-70	A2-70
12	Lock Washer	8.8+Gal.	8.8+Gal.	A2-70	A2-70
13	Belleville Washer	50CrV4	50CrV4	A2-70	A2-70
14	Piston Washer	Ms-58	Ms-58	1.4301	1.4301

mm	inch	DN	Dimensions			Assembly				
			L	H	A	d1		AA		
						Screwed	Socket			
6	1/4"	YVMN 1/4" YVSN 1/4"	85	105	100	R 1/4"	14.2	10.5	10	32
10	3/8"	YVMN 3/8" YVSN 3/8"	85	105	100	R 3/8"	17.6	12.5	10	32
15	1/2"	YVMN 1/2" YVSN 1/2"	100	105	100	R 1/2"	22	15.5	10	36
20	3/4"	YVMN 3/4" YVSN 3/4"	120	120	120	R 3/4"	27.5	16	13	41
25	1"	YVMN 1" YVSN 1"	135	138	140	R 1"	34.5	19	13	50
32	1 1/4"	YVMN 1 1/4" YVSN 1 1/4"	160	154	160	R 1 1/4"	43	21	13	65
40	1 1/2"	YVMN 1 1/2" YVSN 1 1/2"	185	186	180	R 1 1/2"	49	21	13	75
50	2"	YVMN 2" YVSN 2"	220	211	200	R 2"	61.5	26	16	90

\* For temperatures below -10°C, stud and nut material should be stainless steel  
 \*\*\*1.4401 for DN15 and DN20  
 \*\*\*\* Ck22 for DN15 and DN20  
 \*\*\*\*\*NPT Screwed type is available according to ANSI 2.1 1960 on demand

# Balanced Piston Valve YVNB 65-200

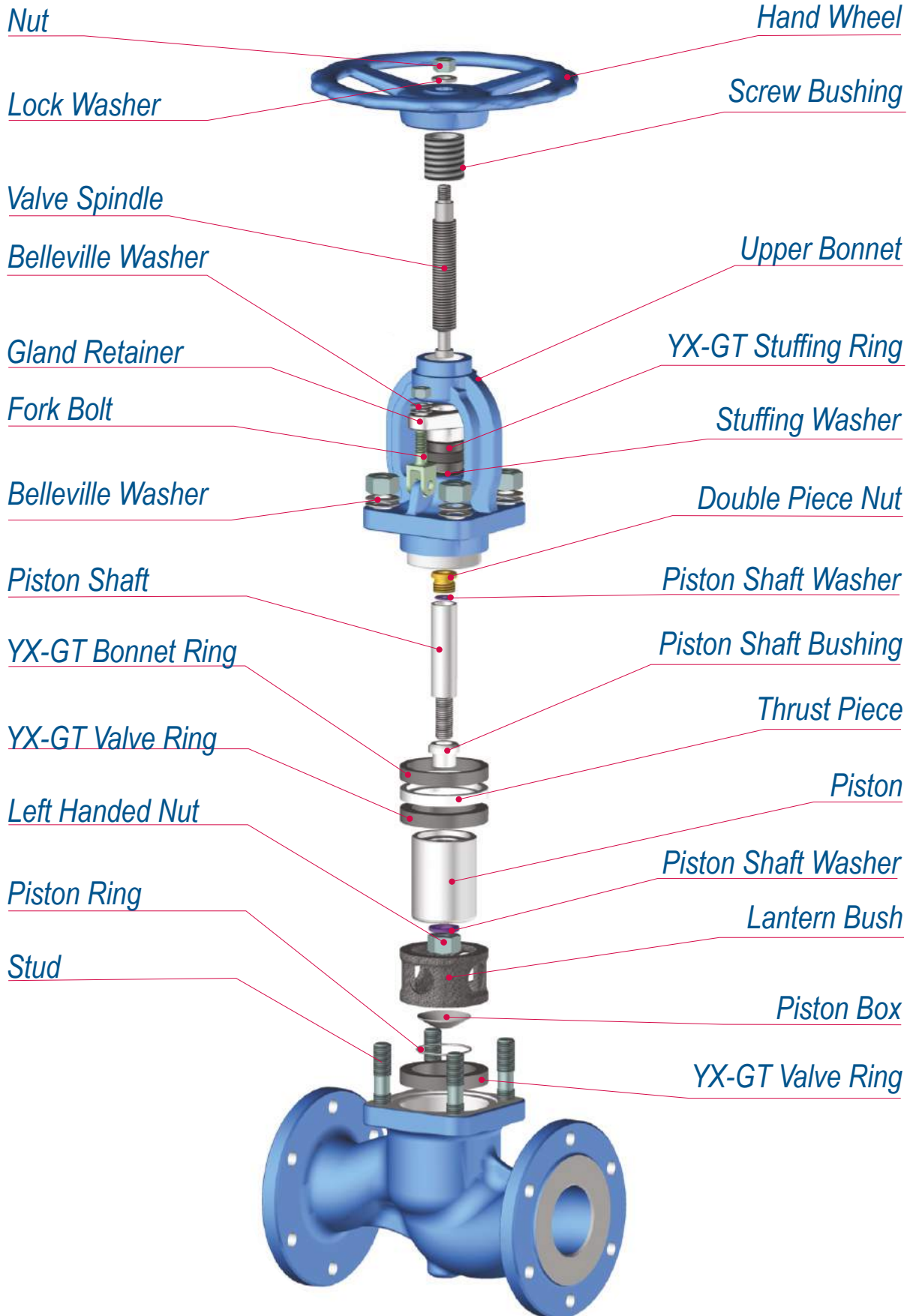

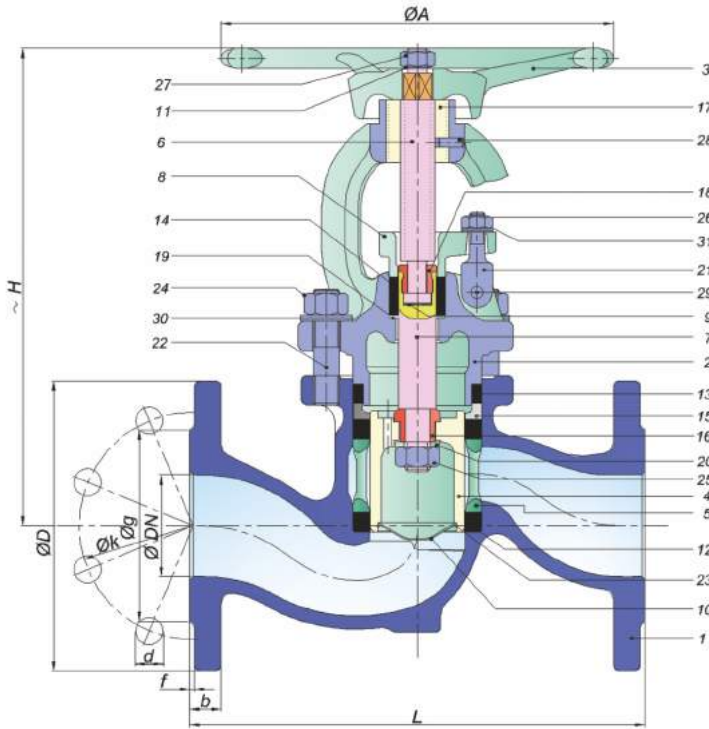

# Balanced Piston Valves

## DN 65 - 200

### Type: YVNB Flanged

Material Type	Cast Iron	Ductile Iron	Cast Steel	Stainless Steel
Size	DN65-200	DN65-200	DN65-200	DN65-200
Pressure Class	PN16	PN25	PN40	PN40
Dimensions	DIN EN 558/1.serie	DIN EN 558/1.serie	DIN EN 558/1.serie	DIN EN 558/1.serie
Assembly	Flanged according to DIN EN 1092-2	Flanged according to DIN EN 1092-2	Flanged according to DIN EN 1092-1	Flanged according to DIN EN 1092-1
Temperature	-10°C +300 °C	-10°C +350 °C	-10°C* +400°C	-10°C* +400°C
Material Code	2	8	7	9
Order Code	YPG.2F__00	YPG.8F__00	YPG.7F__00	YPG.9F__00

### Fluid Types

All kinds of fluids such as water, hot water, high temperature hot water, steam, thermal oil, LPG, fuel oil, pressurized air, etc.

P.No	Part Name	Cast Iron	Ductile Iron	Cast Steel	St. Steel	St. Steel
1	Body	GJL 250	0.7040	1.0619	1.4308	1.4408
2	Upper Bonnet	GJL 250	0.7040	1.0619	1.4308	1.4408
3	Hand Wheel	GJL 200	GJL 200	GJL 200	GJL 200	GJL 200
4	Piston	1.4086	1.4086	1.4086	1.4308	1.4408
5	Lantern Bush	GJL 200 + Phosphate	GJL 200 + Phosphate	GJL 200 + Phosphate	1.4308	1.4408
6	Valve Spindle	St-42	St-42	St-42	1.4301	1.4401
7	Piston Shaft	1.4021	1.4021	1.4021	1.4301	1.4401
8	Gland Retainer	0.7040	0.7040	0.7040	1.4308	1.4408
9	Piston Shaft Washer	1.4301	1.4301	1.4301	1.4301	1.4301
10	Piston Box	1.4301	1.4301	1.4301	1.4301	1.4401
11	Lock Washer	55Si7	55Si7	55Si7	A2-70	A2-70
12	Valve Ring	Graphite	Graphite	Graphite	Graphite	Graphite
13	Bonnet Ring	Graphite	Graphite	Graphite	Graphite	Graphite
14	Stuffing Ring	Graphite	Graphite	Graphite	Graphite	Graphite
15	Thrust Piece	GJL 200 + Phosphate	GJL 200 + Phosphate	GJL 200 + Phosphate	1.4308	1.4408
16	Piston Shaft Bushing	1.4021	1.4021	1.4021	1.4301	1.4401

P.No	Part Name	Cast Iron	Ductile Iron	Cast Steel	St. Steel	St. Steel
17	Screw Bushing	Ms-58	Ms-58	Ms-58	Ms-58	Ms-58
18	Double Piece Nut	Ms-58	Ms-58	Ms-58	1.4301	1.4301
19	Stuffing Washer	St-37+Gal.	St-37+Gal.	St-37+Gal.	1.4301	1.4401
20	Piston Washer	Ms-58	Ms-58	Ms-58	1.4301	1.4401
21	Fork Bolt	St-42	St-42	St-42	1.4301	1.4401
22	Stud	8.8+Gal.	8.8+Gal.	8.8+Gal.	A2-70	A2-70
23	Piston Ring	1.4301	1.4301	1.4301	1.4301	1.4301
24	Nut	8.8+Gal.	8.8+Gal.	8.8+Gal.	A2-70	A2-70
25	Left Handed Nut	A2-70	A2-70	A2-70	A2-70	A2-70
26	Nut M10	8.8+Gal.	8.8+Gal.	8.8+Gal.	A2-70	A2-70
27	Nut	8.8+Gal.	8.8+Gal.	8.8+Gal.	A2-70	A2-70
28	Pin 6x15	St-42+Gal.	St-42+Gal.	St-42+Gal.	A2-70	A2-70
29	Sloted pin 8x22	8.8	8.8	8.8	1.4301	1.4301
30	Belleville Washer	50CrV4	50CrV4	50CrV4	A2-70	A2-70
31	Belleville Washer (20/10.2x11)	50CrV4	50CrV4	50CrV4	A2-70	A2-70

DN		Dimensions			Assembly size																					
mm	inch	Type	L	H	A	PN16						PN25						PN40								
						D	b	g	Hole Nr.	d	k	f	D	b	g	Hole Nr.	d	k	f	D	b	g	Hole Nr.	d	k	f
65	2 1/2"	YVNB 65	290	306	250	185	20	122	4	19	145	3	185	20	118	8	19	145	3	185	22	122	8	18	145	2
80	3"	YVNB 80	310	327	250	200	22	138	8	19	160	3	200	22	132	8	19	160	3	200	24	138	8	18	160	2
100	4"	YVNB 100	350	374	280	220	24	158	8	19	180	3	235	24	156	8	23	190	3	235	24	162	8	22	190	2
125	5"	YVNB 125	400	447	320	250	26	188	8	19	210	3	270	26	184	8	28	220	3	270	26	188	8	26	220	2
150	6"	YVNB 150	480	477	360	285	26	212	8	23	240	3	300	26	211	8	28	250	3	300	28	218	8	26	250	2
200	8"	YVNB 200	600	561	400	340	30	268	12	23	295	3	360	30	274	12	28	310	3	375	34	285	12	30	320	2

\*For temperatures below -10°C, stud and nut material should be stainless steel